

- **LIFT**
- **ACCESSIBLE TOILET**
- **ACCESSIBLE ENTRANCE BY WHEELCHAIR**
- **RAMP**
- **VISUAL ALARM**
- **REFUGE POINT**
- **ACCESSIBLE PARKING**

- G45 Conference Room
- G46A FOH Print Room
- G47 Assistant Head (Marketing, Admissions and Communications)
- G50 Foundation Bursar's PA
- G51 Registrars
- G52 Headmaster's PA/Recruitment Co-ordinator

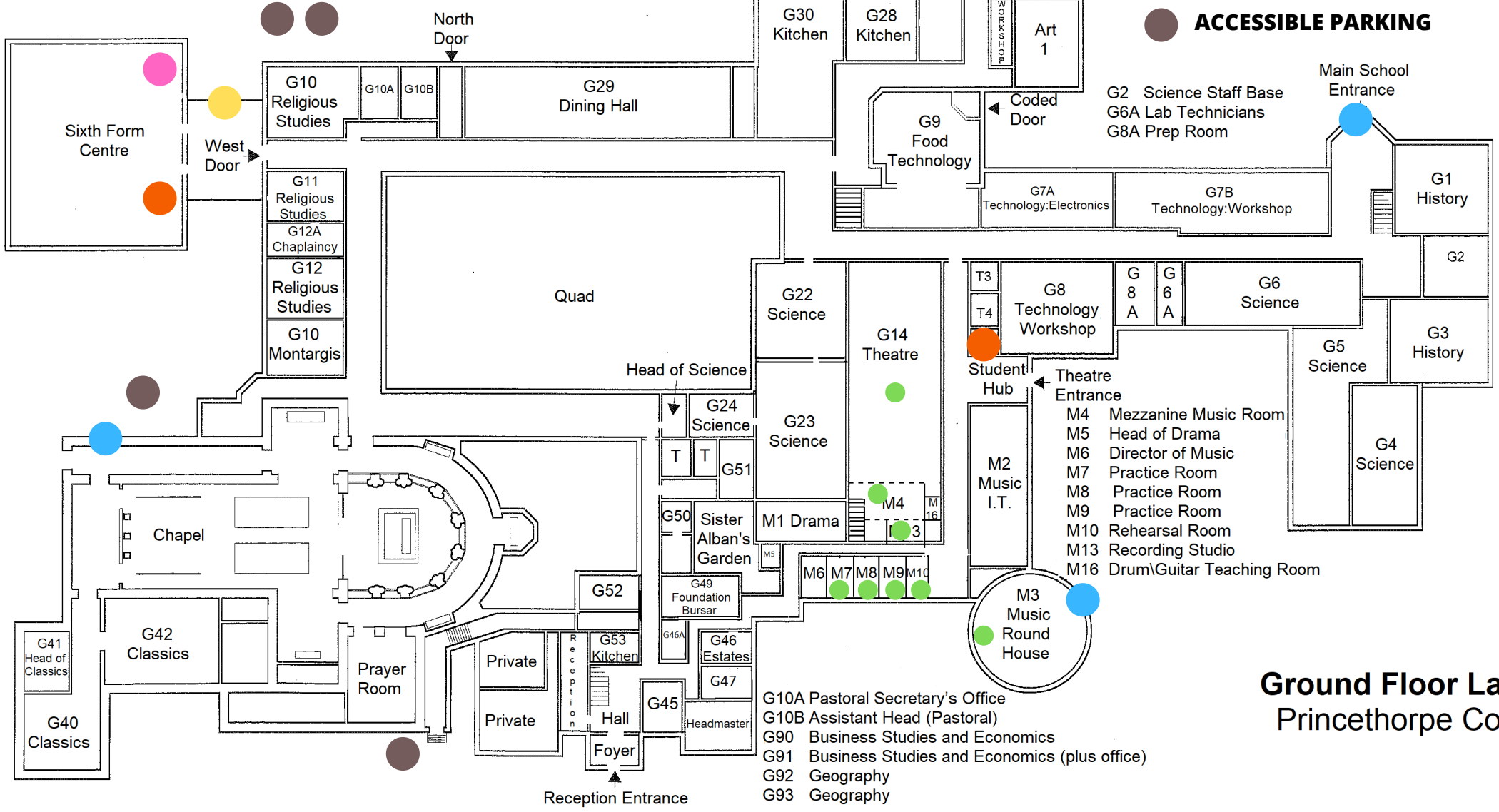
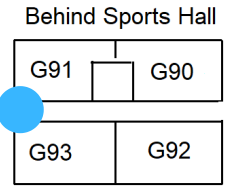
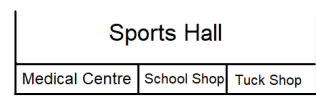

- G10A Pastoral Secretary's Office
- G10B Assistant Head (Pastoral)
- G90 Business Studies and Economics
- G91 Business Studies and Economics (plus office)
- G92 Geography
- G93 Geography

**Ground Floor Layout  
Princethorpe College**

- |   |  |
|---|--|
| F18 Learning Support                              | F39 Assistant Head (Academic/Academic Secretary)                             |
| F19 Learning Support Wellbeing Room               | F40 Assistant Head (Co-curricular)   |
| F20 Learning Support                              | F41 Chevalier Room   |
| F21 Learning Support                              | F42 Head of Fisher House   |
| F22 Learning Support                              | F43 Head of Austin House   |
| F23 Learning Support                              | F44 Head of Ethos  |
| F23A Benedictine Meeting Room                     | F45 Head of Learning Support   |
| F24 Assistant Head (Teaching & Learning)          | F46 Head of Induction and Transition   |
| F25 Assistant Head (Director of Digital Strategy) | F47 Head of More House   |
| F26 Head of History (also classroom)              | F48 Head of Benet House  |
| F30 Assistant Head of Sixth Form                  | F49 Leader of Learning, Innovation and Development and da Vinci Co-ordinator |

- LIFT**
- ACCESSIBLE TOILET**
- ACCESSIBLE ENTRANCE BY WHEELCHAIR**
- RAMP**
- VISUAL ALARM**
- REFUGE POINT**
- ACCESSIBLE PARKING**

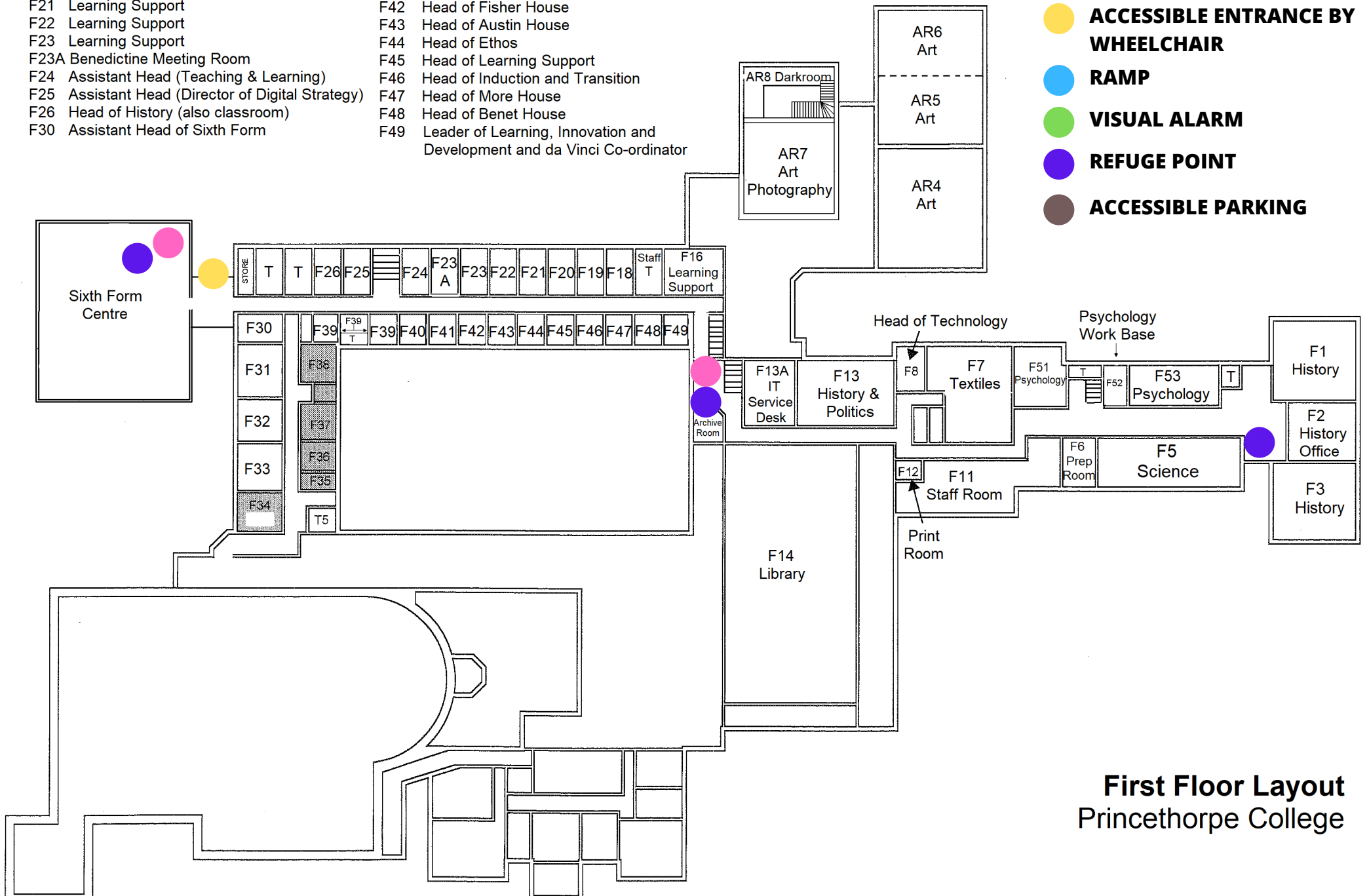

**First Floor Layout**  
Princethorpe College

- S14 Head of Technology
- S16 LAMDA Base
- S17 Learning Support
- S19 Sixth Form Studies
- S20 Sixth Form Studies
- S21 Music Classroom
- S22 Assistant Head (Development)
- S23 Management Account\Bursary Assistant
- S24 Bursary Assistant
- S25 Student Counsellor
- S26 Development Office
- S27 Student Councillor
- S28 Marketing Office
- S29 Geography Base

- S33 Kitchen
- S34 Archivist
- S35 Development Director
- S36 Finance Manager
- S37 Special Projects Manager
- S38 Examinations Officer
- S39 Curriculum Co-ordinator
- S40 DofE Office
- S41 Foundation Data Manager
- S42 Music Store
- S43 Sixth Form Studies
- S44 Sixth Form Studies
- S45 Sixth Form Studies

- **LIFT**
- **ACCESSIBLE TOILET**
- **ACCESSIBLE ENTRANCE BY WHEELCHAIR**
- **RAMP**
- **VISUAL ALARM**
- **REFUGE POINT**
- **ACCESSIBLE PARKING**

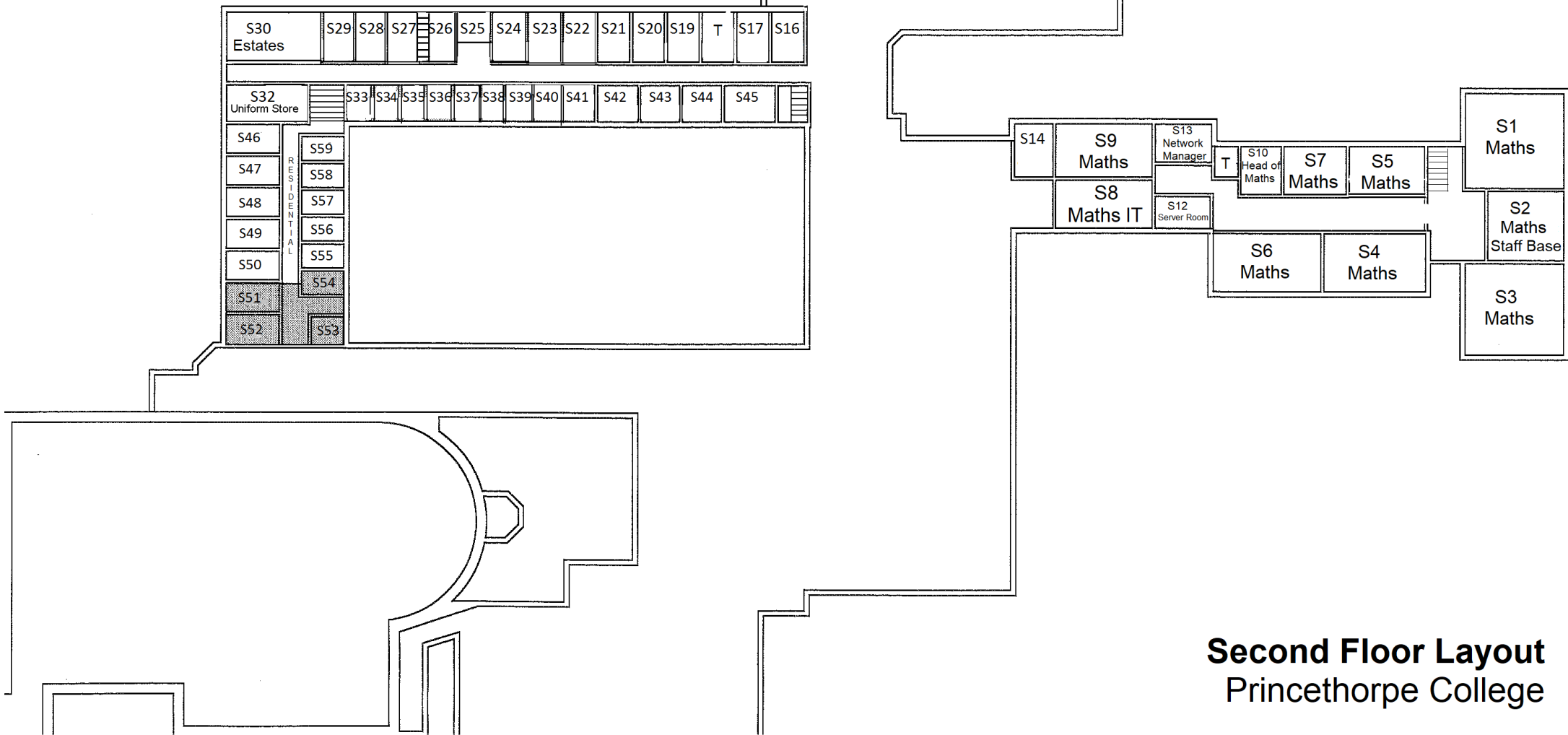

**Second Floor Layout**  
Princethorpe College

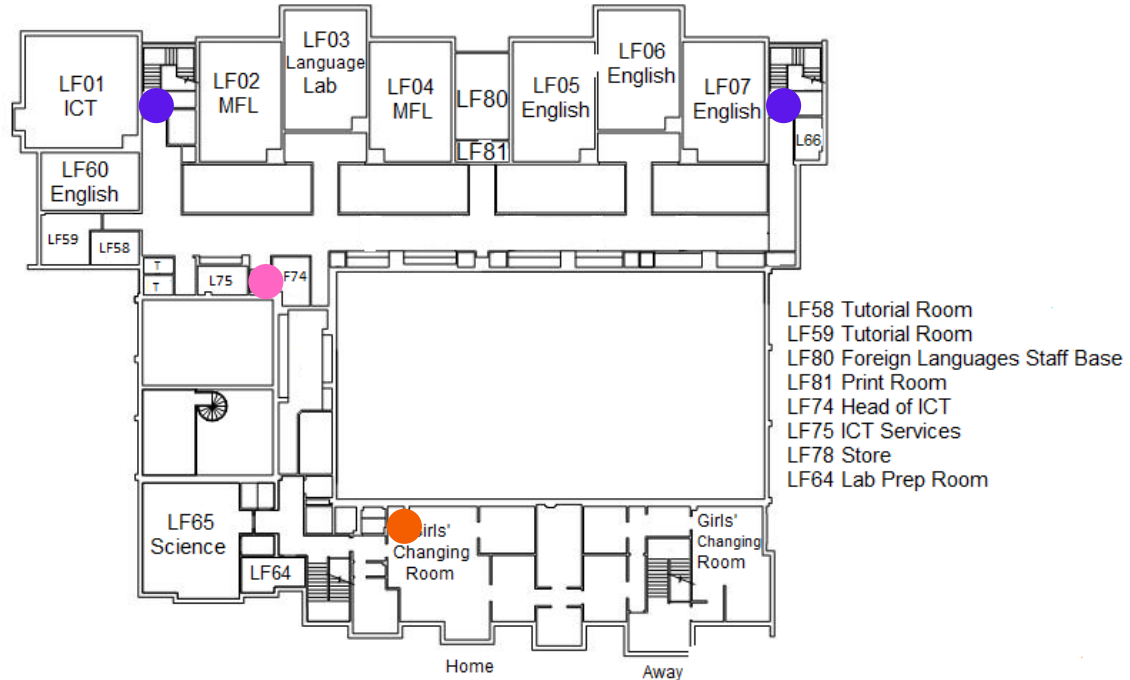
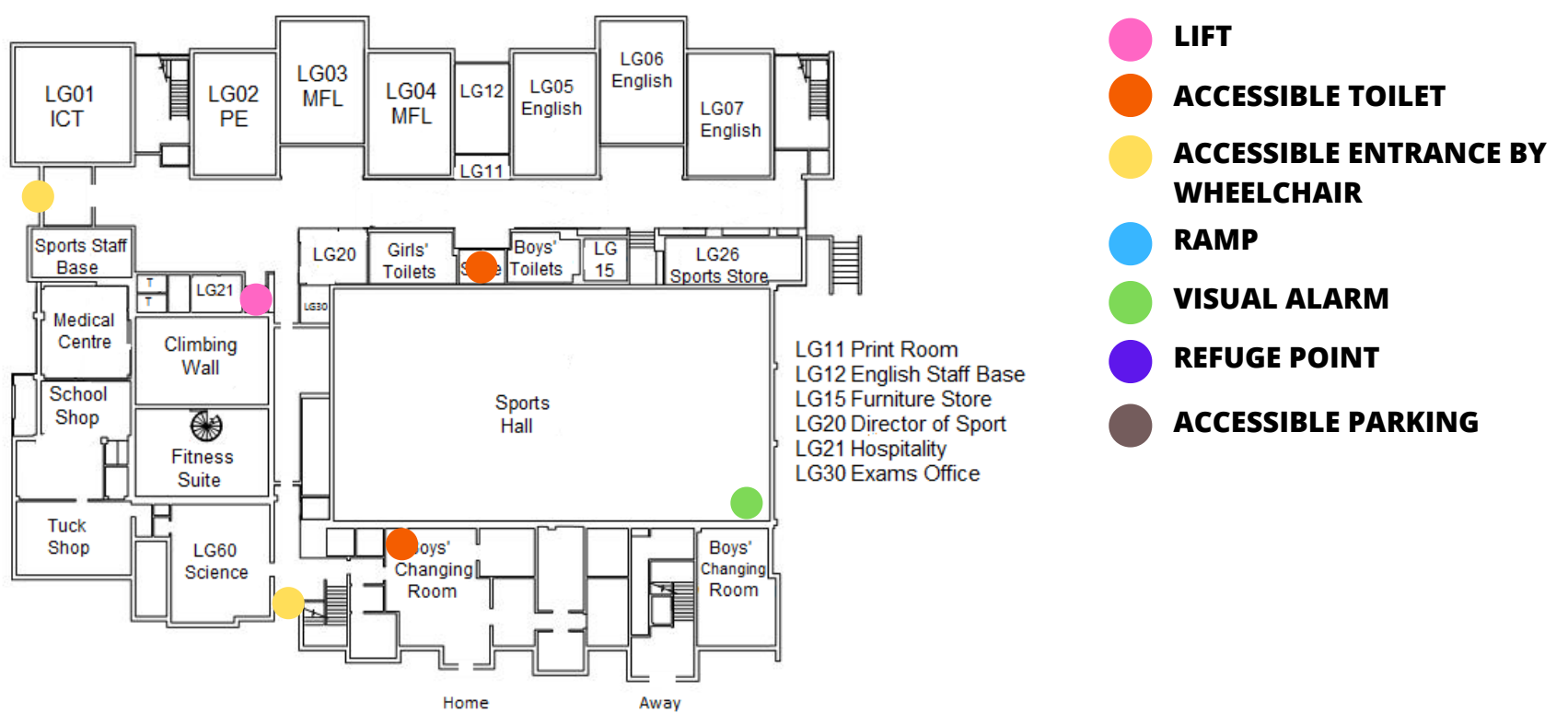

**The Limes First Floor Layout**  
Princethorpe College